

Educational Requirements

Graduation from an accredited college or university with a minimum of a bachelor's degree.

- **Crime Scene Investigation, Digital Evidence, Firearm & Toolmark, and Latent Print** applicants must possess a bachelor's or advanced degree in a chemical, physical, or biological science, forensic science, or other relevant field.
- **Controlled Substances, Trace Evidence, and Toxicology** applicants must possess a bachelor's or advanced degree in a chemical, physical, biological, or forensic science.
- **Biology/DNA** applicants must possess a bachelor's or advanced degree in a chemical, biological, or forensic science.
 - Applicants for the positions of **Forensic Scientist Trainee, Forensic Scientist, and Senior Forensic Scientist** within the **Biology/DNA** section must meet the following additional requirements:
 - Successful completion of a minimum of nine semester or equivalent credit hours of course work covering **all** the following subject areas: Biochemistry, Genetics, and Molecular Biology.
 - Successful completion of coursework covering statistics and/or population genetics.

*Applicants missing **one** required course will be considered provided that course is successfully completed by the end of the training period. Courses with titles other than those listed above may satisfy the requirements as evaluated by the laboratory.*
 - Applicants for the position of **Forensic Scientist Technical Leader** within the **Biology/DNA** section must possess a Master's degree and have successfully completed a minimum of twelve semester or equivalent credit hours of a combination of undergraduate and graduate course work covering the subject areas of biochemistry, genetics, and molecular biology, or other subjects which provide a basic understanding of the foundation of forensic DNA analysis as well as statistics and/or population genetics as it applies to forensic DNA analysis.

Pre-employment Requirements

- If selected for a position you must submit and pass a polygraph examination, extensive background check, drug screen, and psychological interview prior to starting employment.
- You will also be required to provide a known DNA sample for quality assurance purposes.

Benefits

2023 benefits include:

- 10 county-paid holidays, 3 floating holidays, and accrual of sick and vacation leave.
- Parental, caregiver, shared, civic, military, and bereavement leave.
- Dental, medical, and vision insurance.
- Reimbursement of approved education expenses up to \$3,500 per calendar year, as resources allow.
- Access to on-site fitness center.
- Fitness program that pays for classes and memberships in a network of over 160 facilities, studios, and gyms.

- County match of up to 4% of your base bi-weekly earnings towards a retirement saving contribution program.
- Kansas Public Employee Retirement System (KPERs).
- Sick disability pay and provided term life and accidental death and dismemberment insurance.
- Employee Assistance Program to provide confidential assistance regarding physical and emotional health.
- Flexible Spending Accounts (medical and dependent care reimbursement).
- Employee discounts for products, entertainment, attractions, sports, and events.

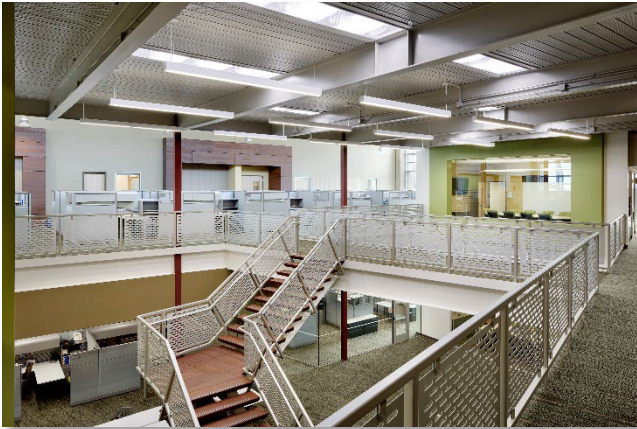

About Us

The Johnson County Sheriff's Office Criminalistics Laboratory is a state-of-the-art, internationally accredited, 62,000 square foot facility located in the southwest quadrant of the Kansas City metropolitan area. We provide forensic services to all law enforcement agencies located or operating within Johnson County, Kansas. Find out more about us at [Johnson County Sheriff | \(jocosheriff.org\)](http://jocosheriff.org).



Photo Credit: www.mrobinsonphoto.com